

DE

Technische Unterlagen

Ökodesignverordnung

EN

Technical Documents

Ecodesign Regulation



MIG 172/6W Schutzgas-Schweissgerät

#20074

1

DE

Materialliste

EN

Bill of materials

Güde®

MIG 172/6W # 20074

Bitte beachten Sie, dass die Zeichnung und Stückliste nicht für die Ersatzteilbestimmung angedacht sind.

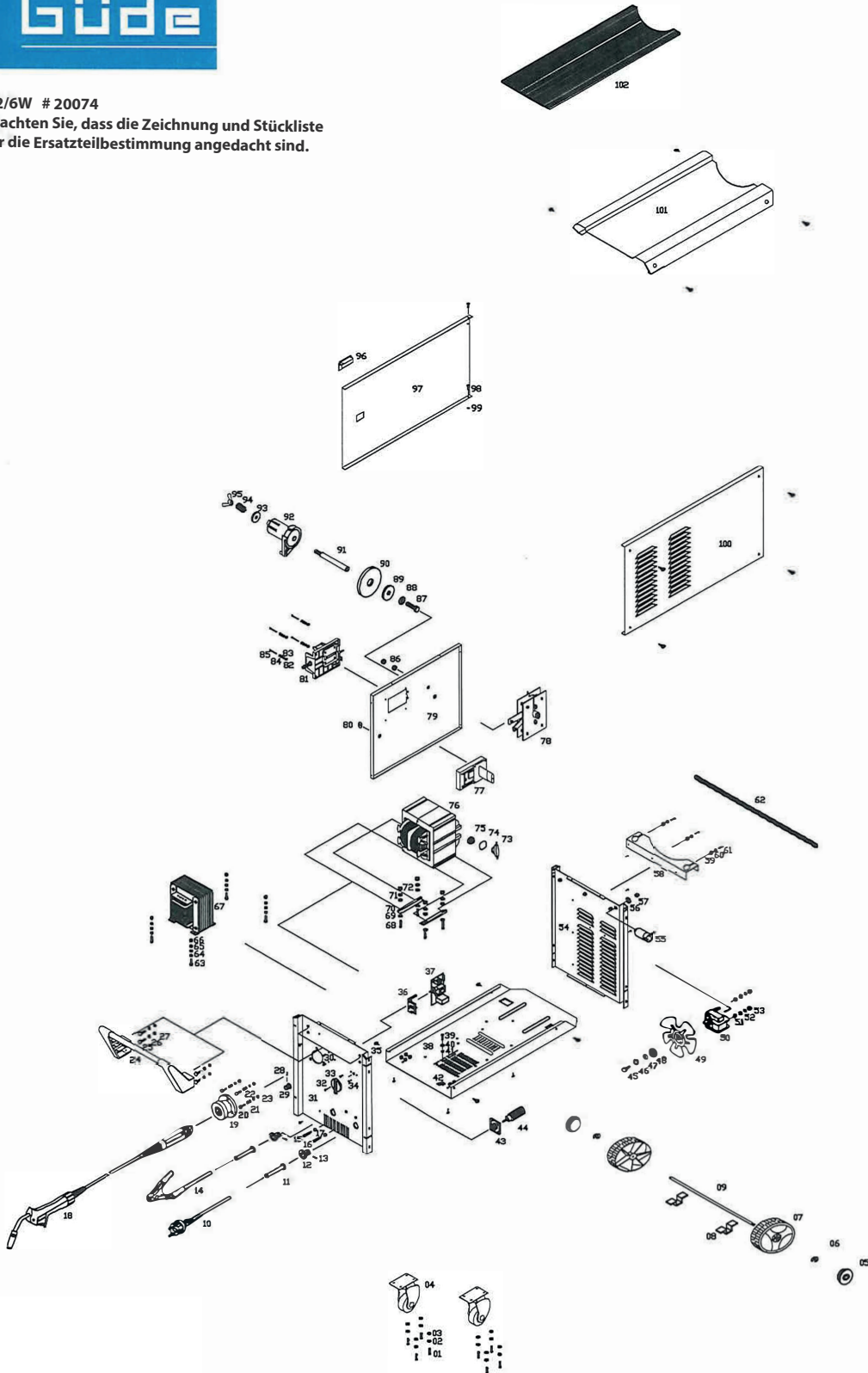

Schutzgas-Schweißgerät MIG 172/6 W



MIG-172/6 W
20074

No	Name	Specifications	Unit	Qty	Material	kg
1	fixup screw	M6X12	pc	8		
2	Flat washer	Φ6	pc	8		
3	Spring washer	Φ6	pc	8		
4	universal wheel	65mm	pc	2		
5	Cover of wheel	PP	pc	2		
6	Clip	Q215	pc	2		
7	Wheel	PP	pc	2		
8	Bracket of axle	Q215	pc	2		
9	Axle	45# Φ8×350mm	pc	1		
10	EURO plug	H07RN-F 3G1.5mm ² FP-006 250V 16A IP44	pc	1		
11	Jacket of cable		pc	2		
12	Lock stud	PVC	pc	2		
13	Self-tapping round-head cross screw	M3×12	pc	2		
14	Earth clamp	KDC-1250	pc	1		
15	Power indicator light	AD-10W-1 AC 230V M10	pc	1		
16	Over-heat indicator light	AD-16Y-1 AC 230V M10	pc	1		
17	Fixup screw of indicator light	M10	pc	2		
18	MIG torch	KDH-8350 280A 35%	set	1		
19	socket of torch		set	1		
20	Screw	M5×20	pc	3		
21	Flat washer	Φ5	pc	6		
22	Spring washer	Φ5	pc	3		
23	Nut	M5	pc	3		
24	Handle		set	1		
25	Screw	M6×12	pc	4		
26	Spring washer	Φ6	pc	4		
27	Flat washer	Φ6	pc	4		
28	Screw	M4X5	pc	1		
29	Potentiometer knob		pc	1		
30	Fixup screw	M4X10 Self-tapping	pc	4		
31	Front panel	Q215	set	1		
32	screw	M3X6 round head crossed	pc	2		
33	Knob of switch		pc	2		
34	Screw	M4X12 flat head crossed	pc	4		
35	Self-tapping screw	M4X10	pc	20		
36	Bracket of circuit board		pc	1		
37	PCB		set	1		
38	motherboard	Q215	set	1		
39	earth ccrew	M4X10	pc	1		
40	Spring washer	Φ4	pc	1		

41	dentiform washer	Φ4	pc	1		
42	earth set	Q215	pc	1		
43	washer		pc	2		
44	shelves switch	HZ8B-20/3/4	pc	1		
45	screw	M4X14	pc	1		
46	Spring washer	Φ4	pc	1		
47	Flat washer	Φ4	pc	1		
48	base of fan leaves		pc	1		
49	fan leaves	Φ140	pc	1		
50	fan motor	YZF-2-30 230/400V 50HZ 30W	pc	1		
51	Flat washer	Φ4	pc	4		
52	Spring washer	Φ4	pc	2		
53	nut	M4	pc	2		
54	back panel	Q215	set	1		
55	electromagnetic valve	DC24V	pc	1		
56	washer	Φ10	pc	1		
57	nut	M10	pc	1		
58	bracket of gas bottle	Q215	pc	1		
59	Flat washer	Φ6	pc	3		
60	Spring washer	Φ6	pc	3		
61	screw	M6X12	pc	3		
62	chain of gas bottle	45#	centi-meter	80		
63	screw	M5X12 hexagon crossed head	pc	4		
64	Flat washer	Φ5	pc	8		
65	Spring washer	Φ5	pc	4		
66	Nut	M5	pc	4		
67	reactance		pc	1		
68	screw of transformer	M5X20 hexagon crossed head	pc	4		
69	Flat washer	Φ5	pc	8		
70	bracket of transformer	Q215	pc	2		
71	Spring washer	Φ5	pc	4		
72	Nut	M5	pc	4		
73	Thermal protection	KDS-R302 128℃ 32A	pc	1		
74	cooling fin	27x27x1	pc	1		
75	daub		gram	50		
76	Main transformer		pc	1		
77	wire feeding motor	KD241 24V 0.4A	pc	1		
78	rectify bridge	180A	pc	1		
79	Clapboard	Q215	set	1		
80	Washer	rubber	pc	1		
81	wire feeding mechanism	PA66	set	1		
82	Nut	M4	pc	4		
83	Spring washer	Φ4	pc	4		
84	Flat washer	Φ4	pc	8		
85	Screw	M4X16	pc	4		
86	screw	M8	pc	2		
87	screw	M10X20 hexagon head	pc	1		
88	Spring washer	Φ10	pc	1		
89	small mat		pc	1		

90	big mat		pc	1		
91	axle for wire-feed spool	1/5kg	pc	1		
92	wire-feed spool	5kg	pc	1		
93	Flat washer	Φ10	pc	1		
94	Spring	Φ1.5x30	pc	1		
95	butterfly nut	M10	pc	1		
96	botton		pc	1		
97	left-side panel	Q215	set	1		
98	screw	M5X10	pc	2		
99	cap-type nut	M5	pc	2		
100	right-side panel	Q215	set	1		
101	top board	Q215	set	1		
102	rubber mat	510X180X3	pc	1		

2

DE

Schaltplan

EN

Circuit diagram

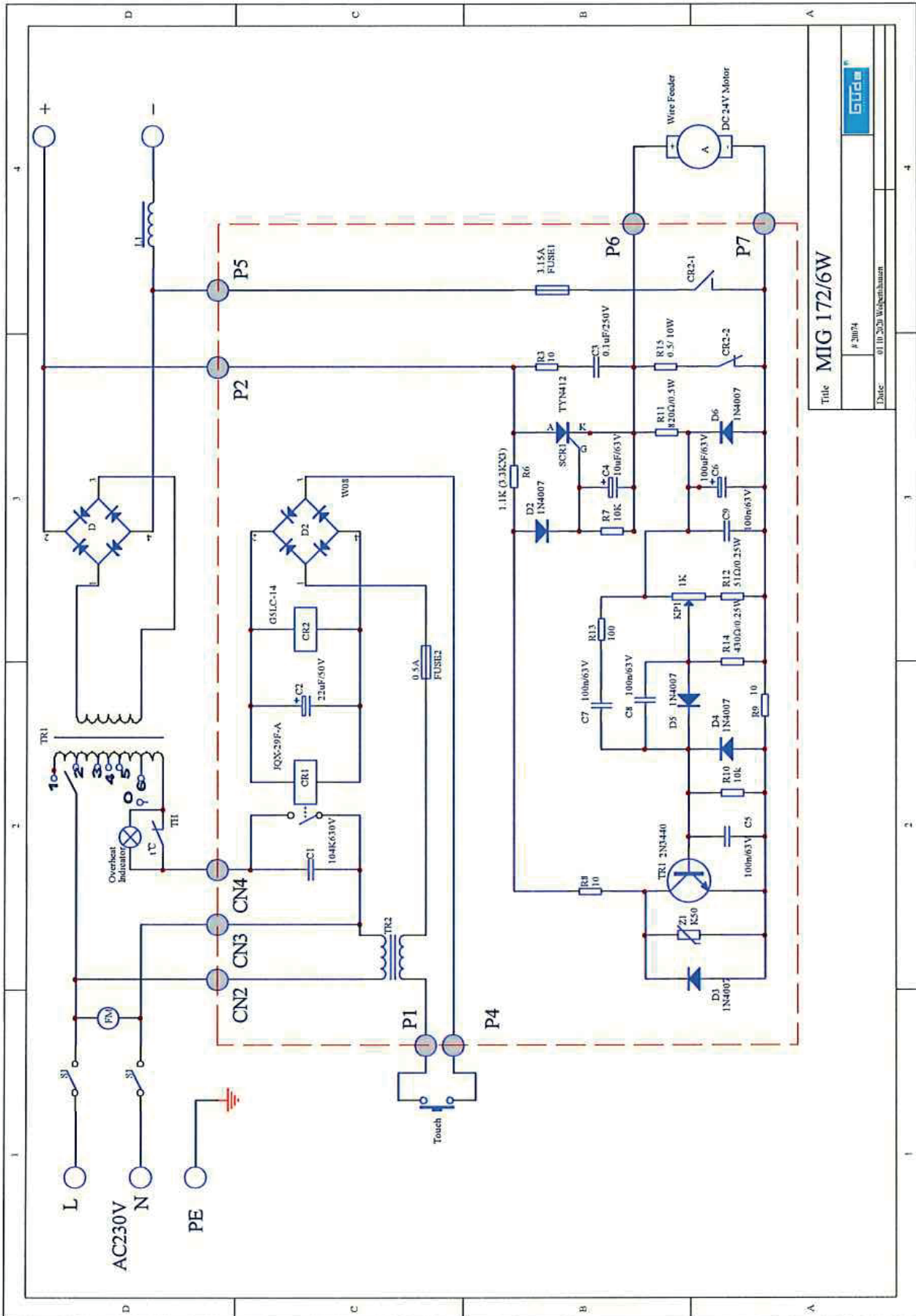

Title MIG 172/6W



20074
Date: 01.10.2020 Wakenhausen

GÜDE GmbH & Co. KG
Birkichstrasse 6
74549 Wolpertshausen
Deutschland
Tel.: +49-(0)7904/700-0
Fax.: +49-(0)7904/700-250
eMail: info@guede.com

